

Parts

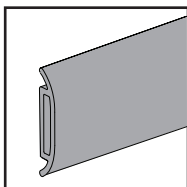

■ 10.25" Split Rail Pairs

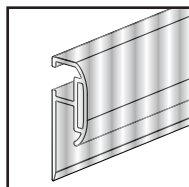

▲ 16.25" Full Rails

■ 10.25" Full Rails

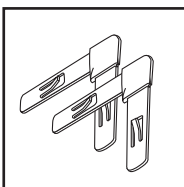

Corner Brackets



Screws & Mollys

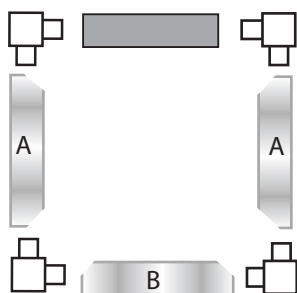
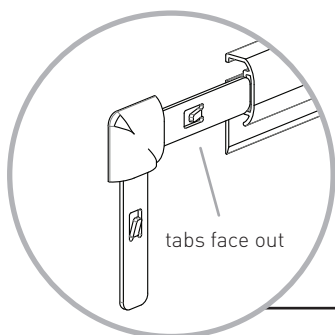

Layout parts in order on the floor before assembly!

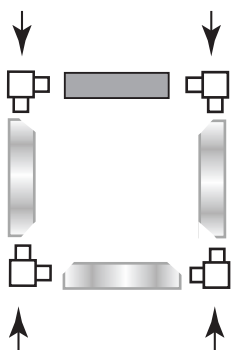

1. Insert brackets into all vertical rails.

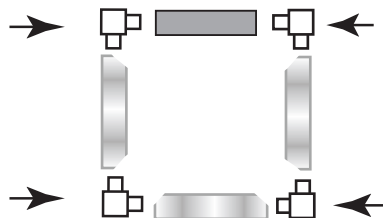

2. Push remaining horizontal rails and assembled vertical rails together to complete assembly.

How To Mount Frame

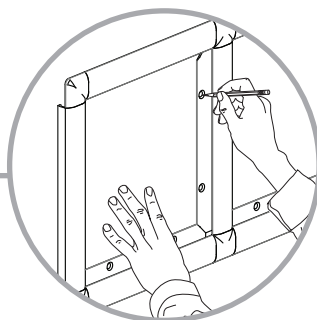

Place frame in desired position on wall, level, and mark.

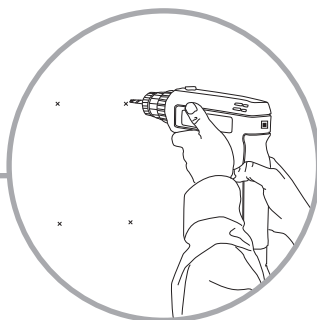

Use a 3/16" bit to drill holes. Insert molly anchor.

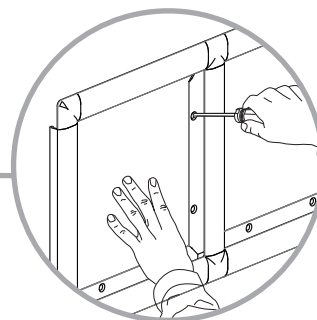

Screw frame into wall.