

Butterfly™ Clips

Butterfly Clip with Cable and Saucer
and Screw Mount Instruction Sheet

Parts

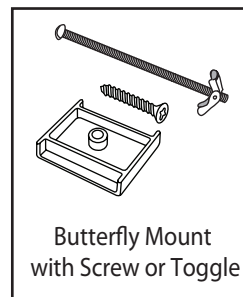
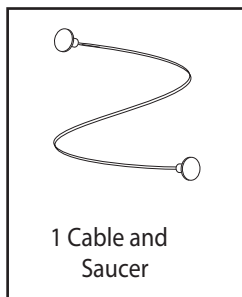
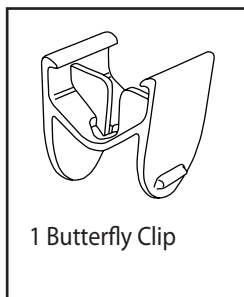

Instructions for Hanging

Step 1

Using a screw driver, screw mount in to ceiling in desired location. (Figure 1)

Note: Use 1 inch wood screw for wood and other solid ceilings. Use 3 inch toggle screw for drywall and other hollow ceilings.

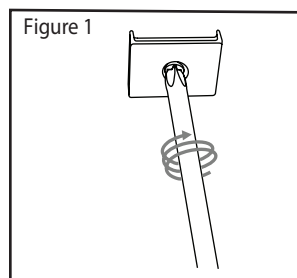

Step 2

Insert saucer through slot in Butterfly Clip. (Figure 2)

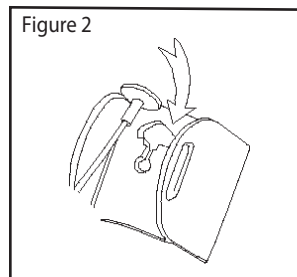

Step 3

Place saucer on side of smaller channel. (Figure 3)

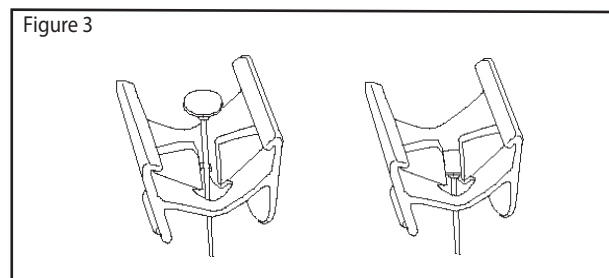

Step 4

Squeeze “wings” of Butterfly Clip and attach to mount. (Figure 4)

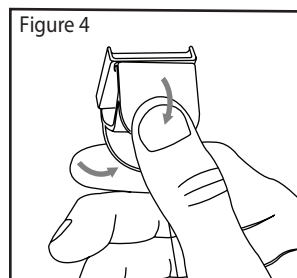

Butterfly™ Clip is a trademark of Rose Displays, Ltd. Neither the manufacturer nor any sales agent may be held liable for injury, loss or damage resulting from the use of these products.
Part #06INSButterflyClipSaucerPlusScrewMount

rose displays

The Signware Specialists

35 Congress Street, Salem, MA 01970

Tel# 1-800-631-9707 Fax# 1-800-560-2890

e-mail: signware@rosedispays.com