

# Myriad Systems

## Instruction Sheet Add-On Kit Index

Click on each kit to access individual add-on kit instruction sheet or scroll down to view all instruction sheet

**KIT A**

Graphic/Storage Base



**KIT B**

Flat Base

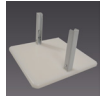

**KIT C**

Upright Frame



**KIT D**

Crossbar



**KIT E**

Center Graphic



**KIT F**

Grid Panel w/ Hooks

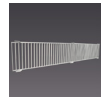

**KIT G**

Shelf/Tray Set

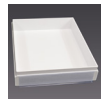

**KIT H**

Graphic Header



**KIT I**

Freestanding Banner

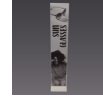

**KIT J**

Footwear Shelves



**KIT K**

Gift Card Tray



**KIT L**

Accessory Hangbar



**KIT M**

Side Mount Graphic Holder



**KIT N**

12pc Hook Set- 4" Long



**KIT O**

6pc Frame Connector



**KIT P**

Footwear Shelves



Scan QR code to watch the Myriad Video

# Myriad™ Kit A

Graphic/Storage Base

**\*Before You begin assembly, please locate and ID all parts listed**

**A** (2) Top Connectors



**B** (2) Bottom Connectors



**C** (1) Bottom Cover

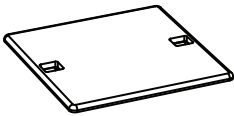

**D** (1) Base Bottom

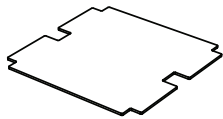

**E** (4) Base coroplast panels

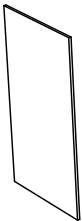

*\*Graphics supplied by others*

**F&G** (2) Side Frames

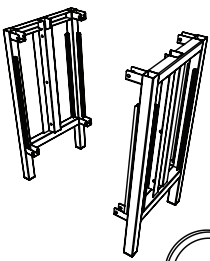

**H** (2) Clevis Pins



**1** 1A) Align and install the 4 base cross tube connectors onto one of the side frames. Be sure to align the locking feature with the holes in the connectors. Depress and slide the top frame connectors into place until they click. **(Illustration 1)**. 1B) Next install the remaining side onto the base cross connectors.

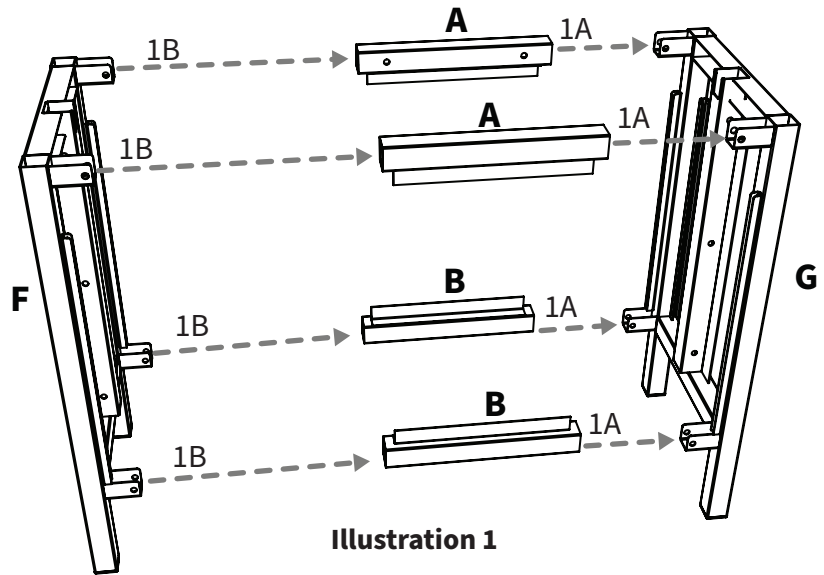

**Illustration 1**

**2** Insert the base bottom into the assembly (on an angle) as shown. Lay flat on top of the inside base frame **(Illustration 2)**.

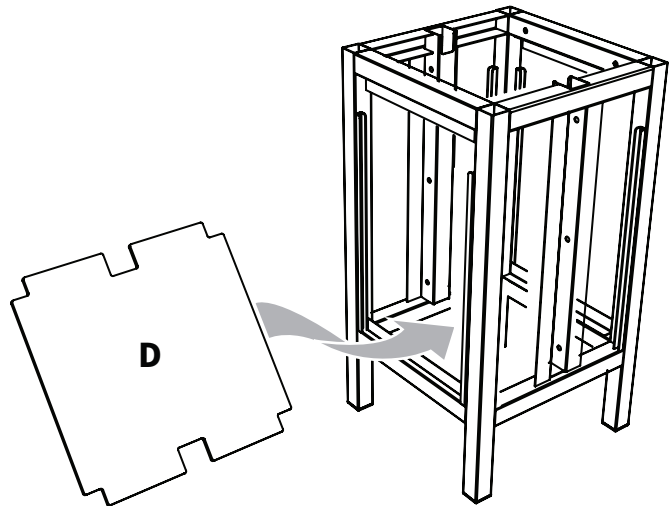

**Illustration 2**

99ROS150KITA

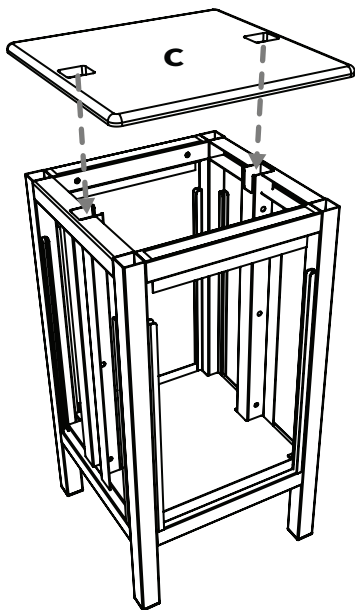
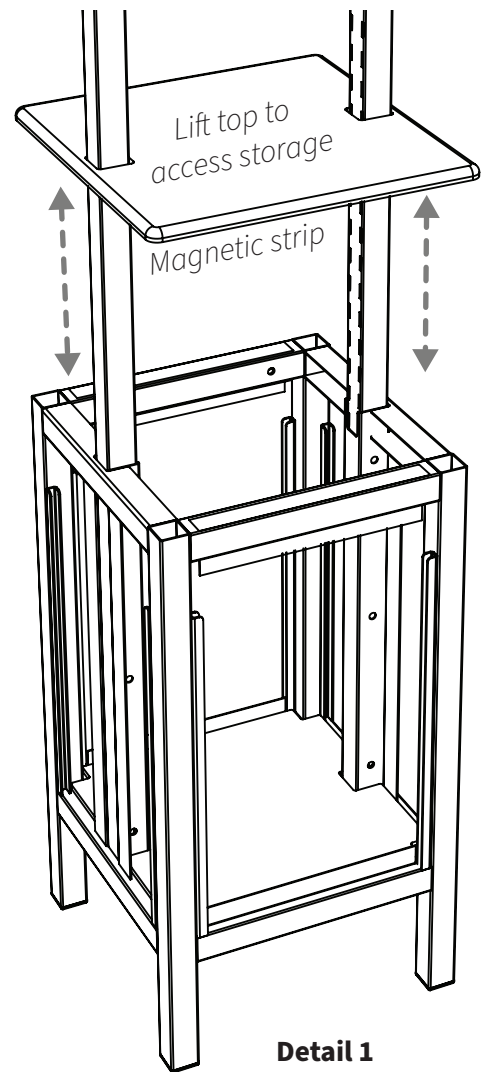

**Illustration 3**

**3** The top cover of the base is magnetic. Place the base top onto the assembled base frame. (Be sure to align the holes in the top with the inner frame channels inside the base assembly) - **Illustration 3**.

**4** Slip the upper frame through the square holes on the base cover and into the channels in the base. (\*refer to the instructions on upright page for interlocking and height adjustment).

**5** Slip the base graphics into the top corners of the channels. Carefully flex the graphic as you slip them downward into position. - **Detail 2** (Repeat this step on the other three sides)



**Detail 1**

\*To Assemble Upper Frame:  
Refer to Frame Kit C  
Assembly Instruction Sheet

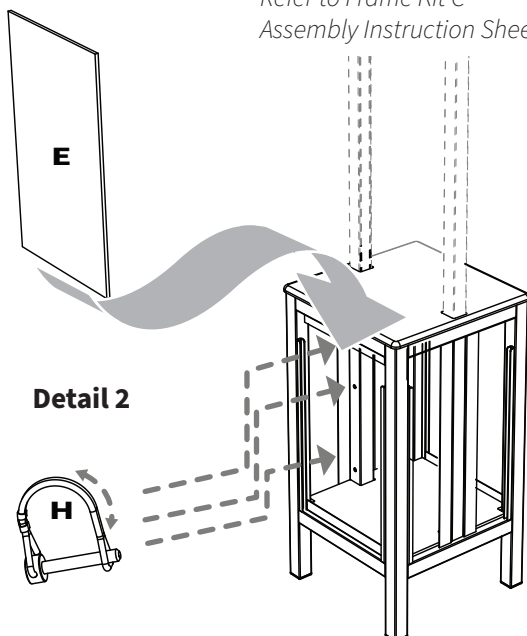

**Detail 2**

**\*The base can be used to store extra parts, merchandising accessories or extra product**

**6** To access storage you can either:  
A) Remove accessory merchandising kits from the bottom of the upper frame then lift the top cover (**Detail 1**).

Or:

B) Gently Pull the graphic up and out of the front or back graphic channels (**Detail 2**).

**7** Refer to the instruction sheet included with the merchandising accessory kit along with your store planogram for merchandising setup and product layout.

# Myriad™ Kit B

Flat Base

**\*Before You begin assembly, please locate and ID all parts listed.**

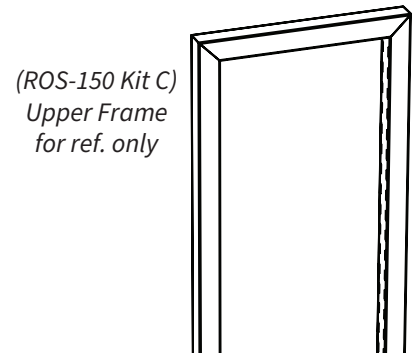
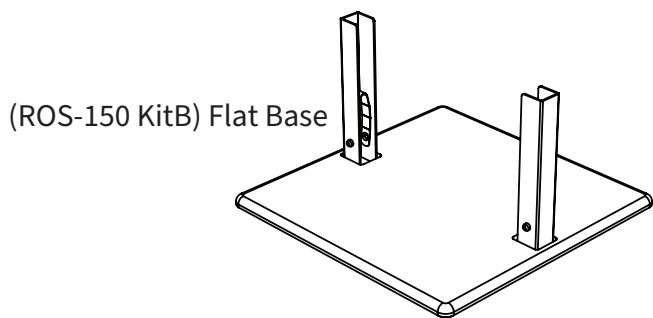

1

Please Note: The Kit B (Base) ships fully assembled. The following is instructions to attach it to kit C (Frame).

Slip the upper frame (Kit C) over the posts on the base. With one hand at each of the frame bottoms, press the locking features and slide the frame completely onto the base. Frame is connected securely when you hear clicks at both frame bottoms. **(Detail 1)** \*Be careful not to pinch fingers between the frame and base.

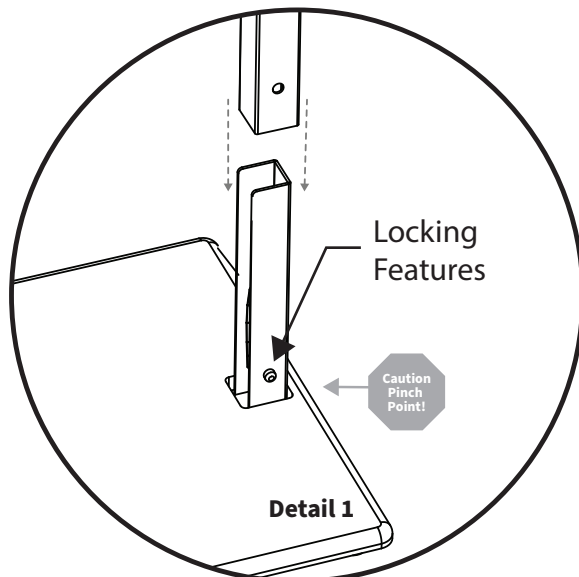

Detail 2

2

Refer to the instruction sheet included with the merchandising accessory kit along with your store planogram for merchandising setup and product layout.

99ROS150KITB

Myriad™ is a trademark of Rose Displays, Ltd. Neither the manufacturer nor any sales agent may be held liable for injury, loss or damage resulting from the use of these products.

500 Narragansett Park Drive Pawtucket, RI 02861 | 800.631.9707 | www.rosedisplays.com | signware@rosedisplays.com

**rose** displays  
The Signware™ Specialists



# Myriad™ Kit C

## Upright Frame

**\*Before You begin, please ID which base you are assembling  
(Flat Base-kit B instructions are on the reverse side)**

### For assembly to the Graphic Base (Kits A to C)

- 1** Slip the upper frame into the square holes on the top of the base. With one hand at each of the frame bottoms, slide the frame into the base. **(Detail 1)** Align the holes in the frame with the desired frame height position. Insert the clevis pin and lock the safety wire back over the end of the pin. *\*Be careful not to pinch fingers under the ends of the frame tubing.*

**Please Note:** This frame can be adjusted to three programmed heights. To adjust height, remove the locking pin, slide the desired position aligning the holes then replace the pin. Be sure to re-lock the safety wire on the end of the pin to complete adjustment.

*\* Do not load merchandising kits and product unless the frame is locked in one of the three positions.*

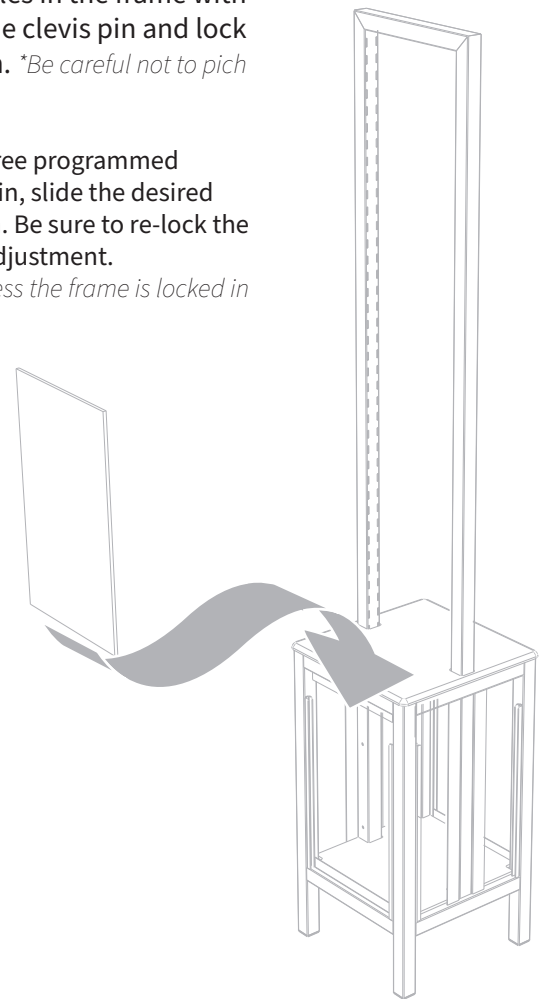
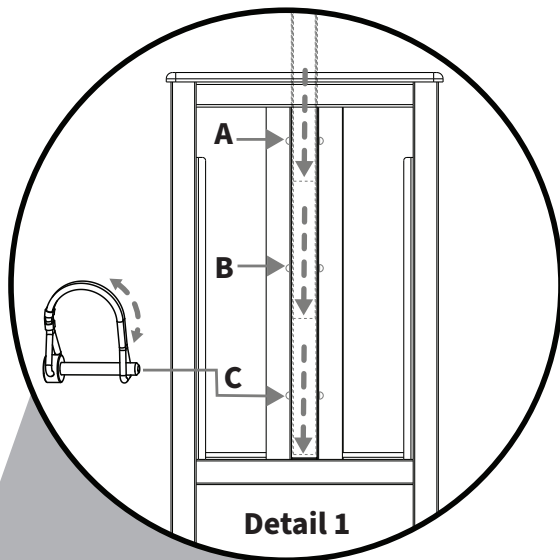
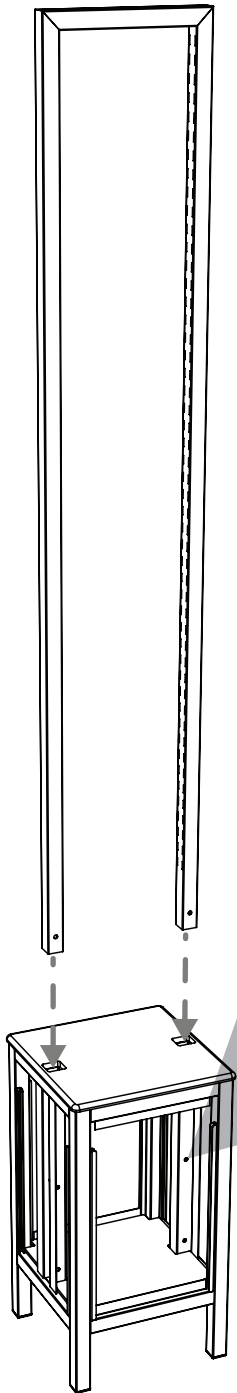

*To Assemble Graphic Base:  
Refer to Base Kit A Assembly  
Instruction Sheet*

- 2** Slip the base graphics into the top corners of the channels. Carefully flex the graphic as you slip them downward into position. *(Repeat this step on the other three sides)*

- 3** Refer to the instruction sheet included with the merchandising accessory kit along with your store planogram for merchandising setup and product layout.

99ROS150KITC

## For assembly to the Flat Base (Kits B to C)

- 1 Slip the upper frame over the posts on the base. With one hand at each of the frame bottoms, press the locking features and slide the frame into the base. **(Detail 2)** Frame is connected securely when you hear clicks at both frame bottoms.

*\*Be careful not to pinch fingers under the ends of the frame tubing.*

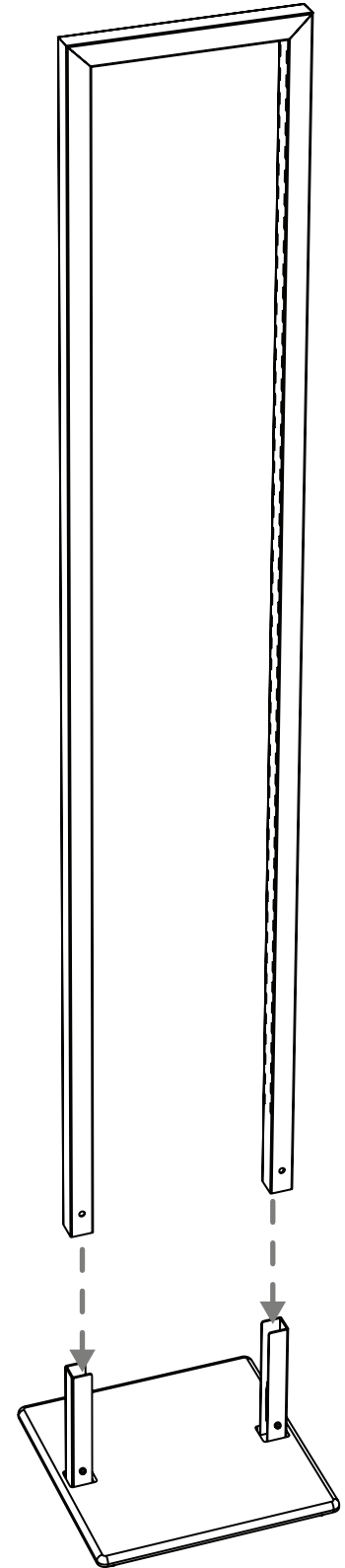
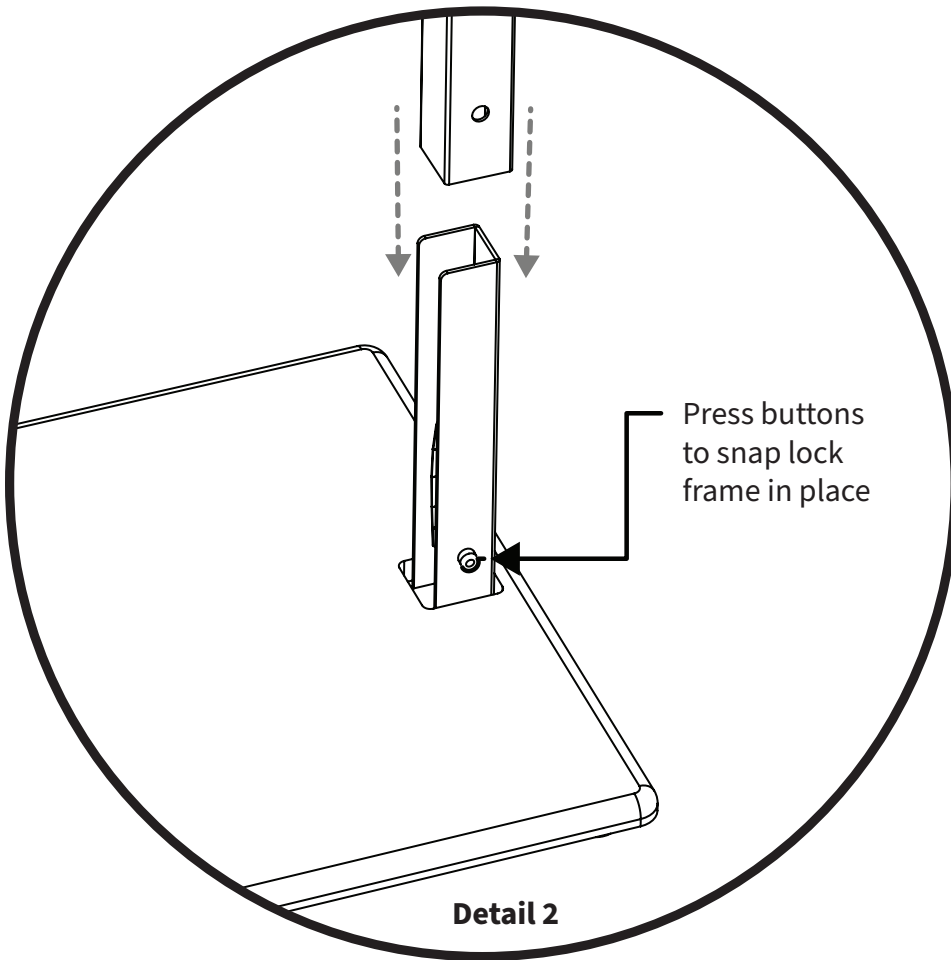

- 2 Refer to the instruction sheet included with the merchandising accessory kit along with your store planogram for merchandising setup and product layout.

P2

# Myriad™ Kit D

## Crossbar Kit

**\*Before You begin, please locate and ID all parts listed for assembly**

**A** (8) Frame Connector Clips

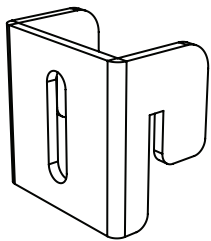

**B** (4) Hangbars

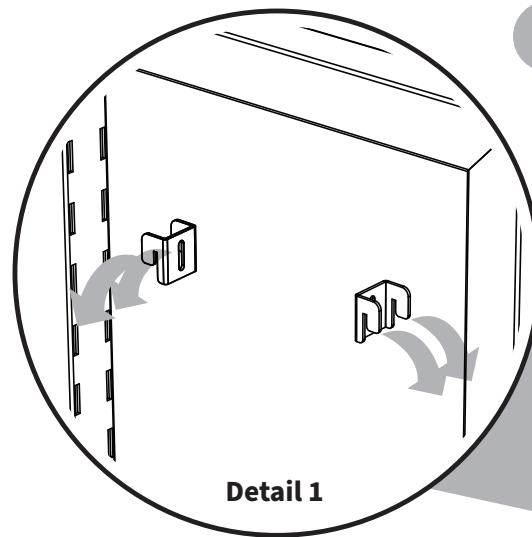
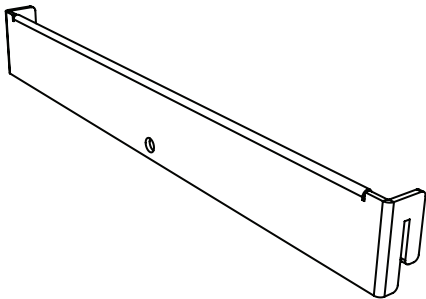

**Detail 1**

**1** Install the frame connector clips into the slots on the inside faces of the frame. **(Detail 1)**

*\*Be sure to count the slot position on the both sides to ensure the bar installs level.*

**2** Install the hook bars onto the frame connector clips **(Detail 2)**.

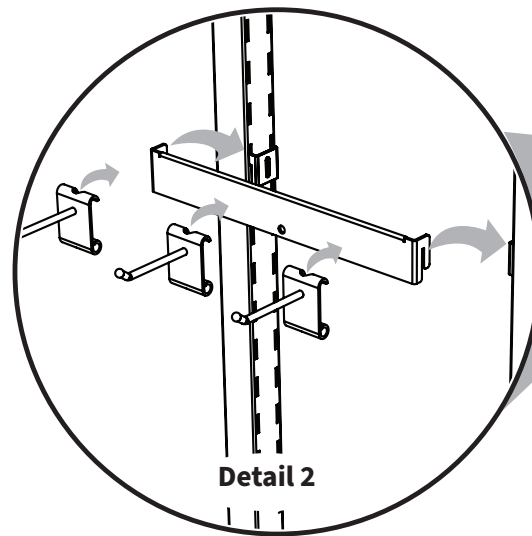

**Detail 2**

**3** Refer to your store planogram for merchandising setup and product layout. *This kit can be used alone with J-cards or be outfit with peg hooks or card pockets.*

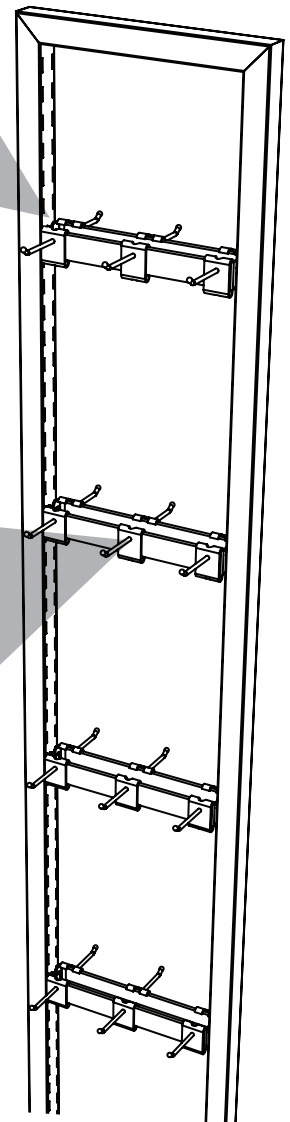

99ROS150KITD

Myriad™ is a trademark of Rose Displays, Ltd. Neither the manufacturer nor any sales agent may be held liable for injury, loss or damage resulting from the use of these products.

500 Narragansett Park Drive Pawtucket, RI 02861 | 800.631.9707 | [www.rosedisplays.com](http://www.rosedisplays.com) | [signware@rosedisplays.com](mailto:signware@rosedisplays.com)

**rose/displays**  
The Signware™ Specialists

# Myriad™ Kit E

## Center Graphic

**\*Before You begin, please locate and ID all parts listed for assembly**

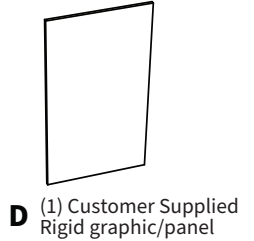
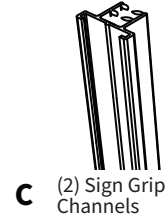
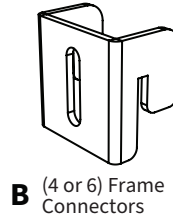
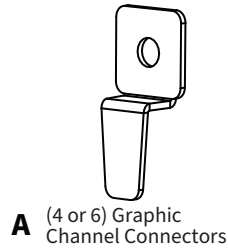

**1** Starting from the ends, Install the Graphic Channel support tabs into the track features on the graphic channel (**Refer to Illustration 1**). Be sure they are all facing the same direction.  
*\* For large graphic installations, 6 will be supplied and for small graphics, 4 will be supplied.*

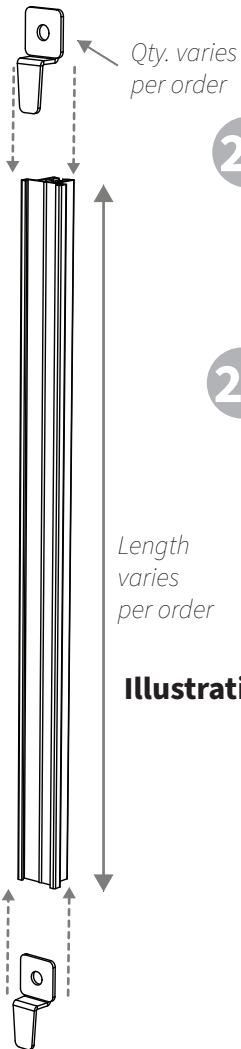
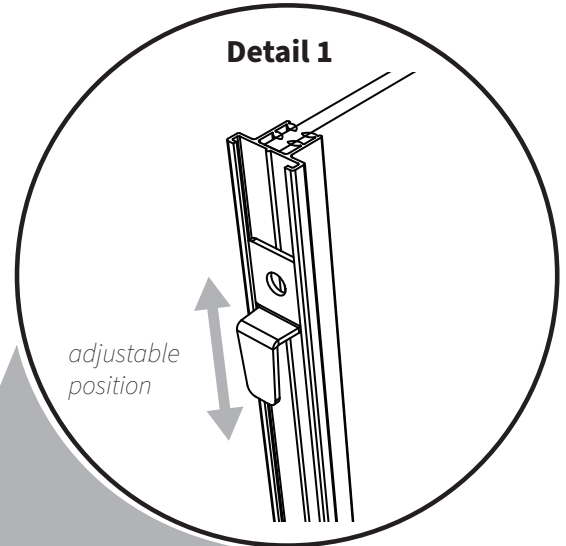

**2a** Adjust positions so the support tabs are symmetrical on left and right channels (**Detail 1**) - \* clips are designed for friction fit, press carefully and firmly to adjust.

**2b** Press the edges of the graphic into the grip features of the side channels. (**Illustration 2**) -  
*\*Be careful not to damage the graphic*

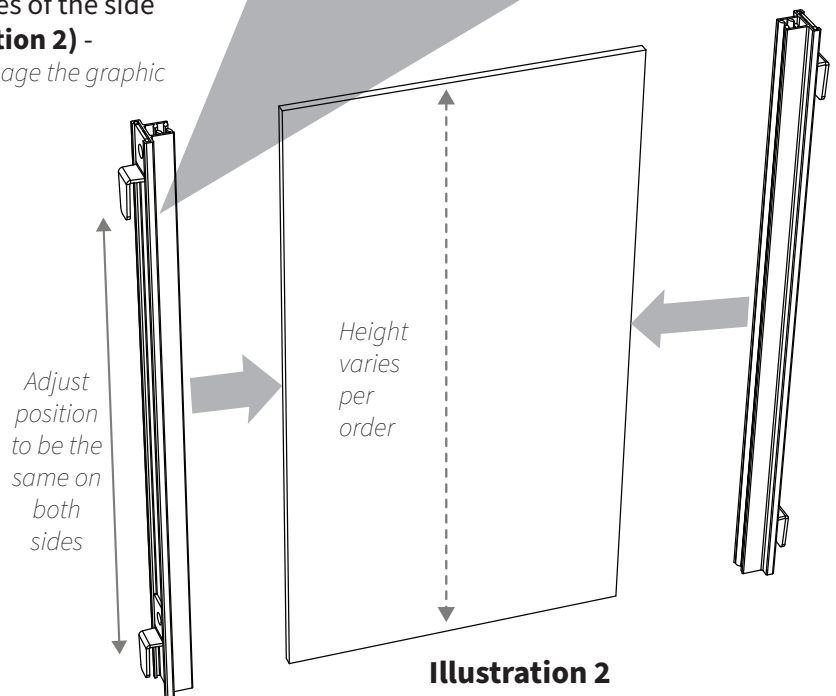

3

Install the (4 or 6) frame connectors into the slots on the inside faces of the frame. **(Detail 1)**

*\*Be sure to count the slot position on the both sides to ensure the grid panel installs level.*

**Tip:**  
If you are assembling product merchandising kits, it's best to install all of their frame connectors in position before installing the center graphic panel

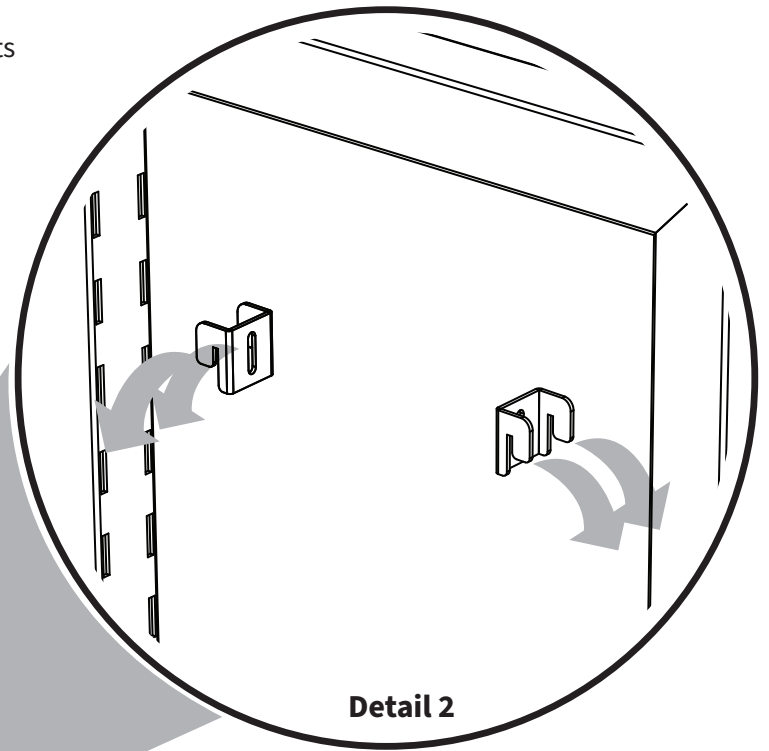

Detail 2

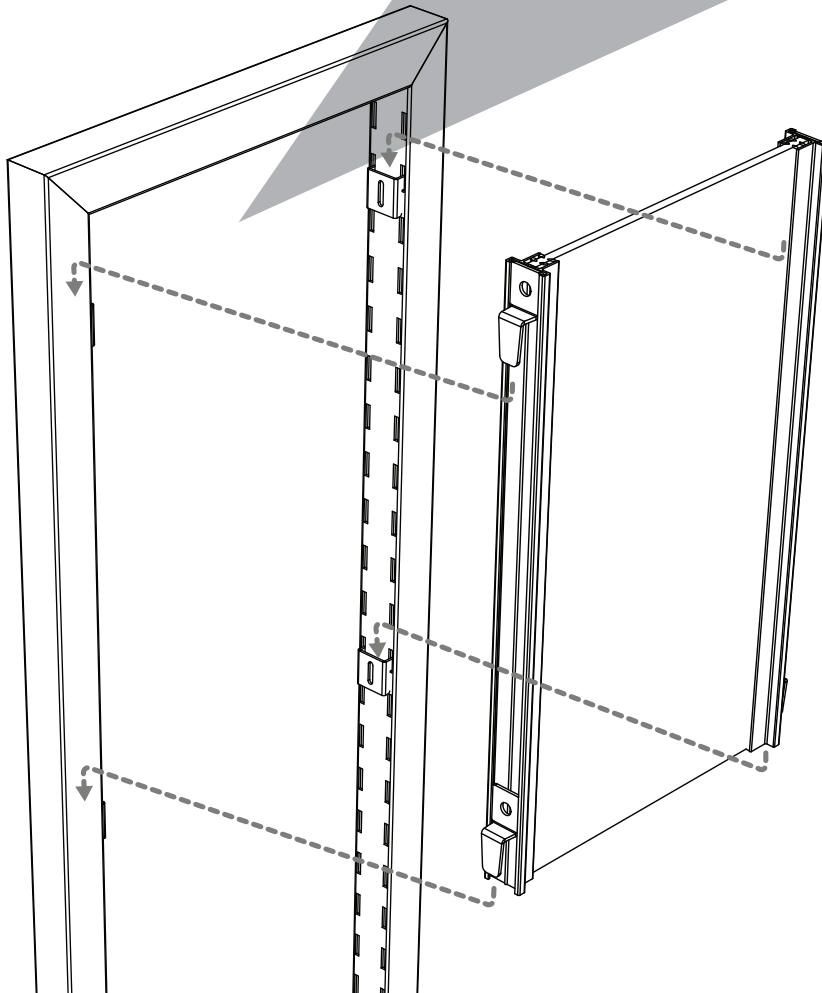

4

Align the channel connectors on above the cooresponding frame connectors. Press down firmly to engage. *\*If properly aligned all clips will seat in the corresponding frame connectors.*

5

Refer to your store planogram for the remainder of merchandising setup and positioning.

# Myriad™ Kit F

## Grid Panel with Hooks

**\*Before You begin, please locate and ID all parts listed for assembly**



**A** (6) Frame Connector



**B** (1) Grid Frame

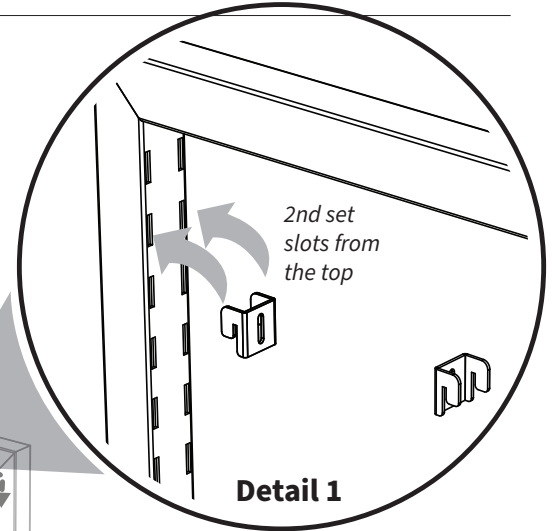

**Detail 1**

**1** Install the (6) frame connector clips into the slots on the inside faces of the frame. **(Detail 1)** *\*Be sure to count the slot position on the both sides to ensure the grid panel installs level.*

**2** Align the 6 tabs on the side of the wire grid frame above the frame connectors. Press down firmly to engage. *\*If properly aligned all clips will seat in the corresponding frame connectors.*

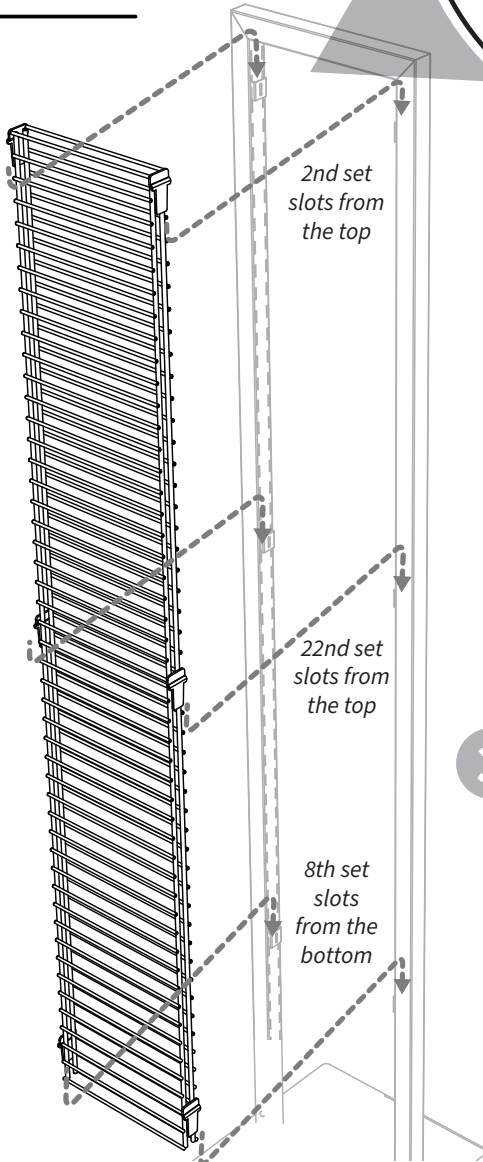

**3** Refer to your store planogram for merchandising setup and product layout. *This kit can be used alone with J-cards or be outfit with peg hooks or card pockets.*

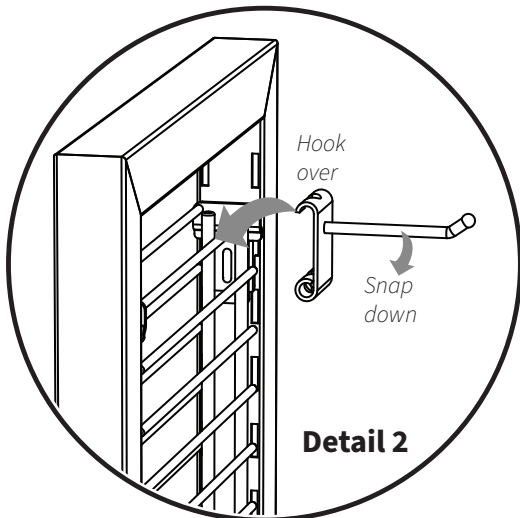

**Detail 2**

99ROS150KITF

Myriad™ is a trademark of Rose Displays, Ltd. Neither the manufacturer nor any sales agent may be held liable for injury, loss or damage resulting from the use of these products.

500 Narragansett Park Drive Pawtucket, RI 02861 | 800.631.9707 | [www.rosedisplays.com](http://www.rosedisplays.com) | [signware@rosedisplays.com](mailto:signware@rosedisplays.com)

**rose/displays**  
The Signware™ Specialists

# Myriad™ Kit G

## Shelf/Tray Set

**\*Before You begin, please locate and ID all parts listed for assembly**



**A** (8) Frame Connector

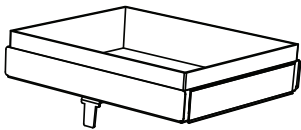

**B** (4) 2 part Shelf

**NOTE: Shelves can be set up 3 ways:**

1 - Shallow tray (without inner liner)

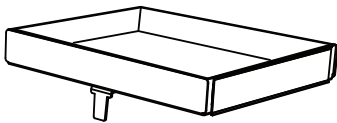

2 - Taller Tray (with inner liner)

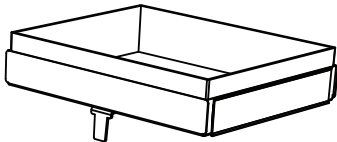

3 - Platform (flip liners over)

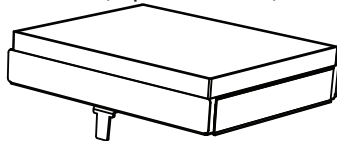

**1** Install the (8) frame connector clips into the slots on the inside faces of the frame. **(Detail 1)** *\*Be sure to count the slot position on the both sides to ensure the shelf installs level.*

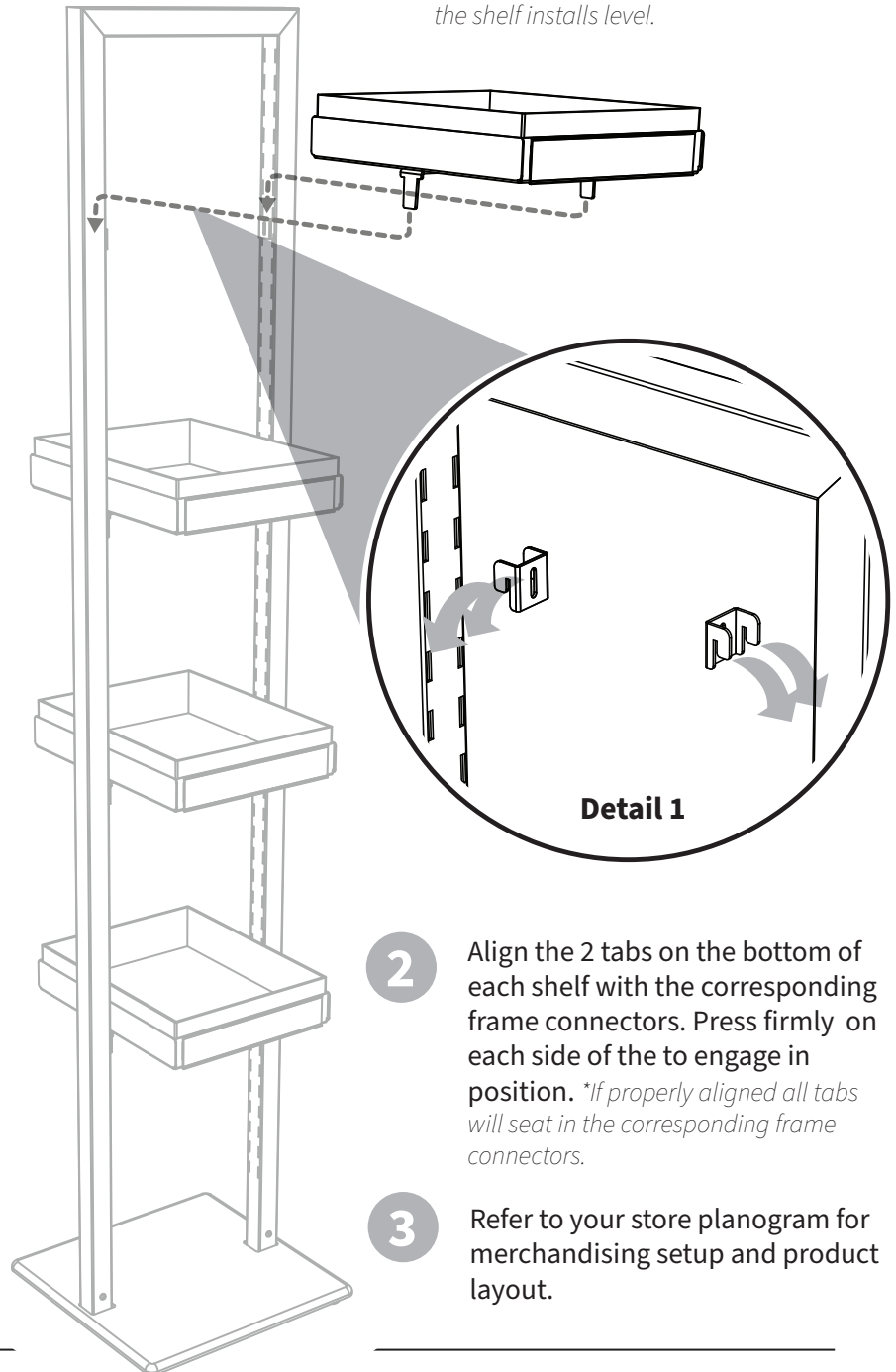

**2** Align the 2 tabs on the bottom of each shelf with the corresponding frame connectors. Press firmly on each side of the to engage in position. *\*If properly aligned all tabs will seat in the corresponding frame connectors.*

**3** Refer to your store planogram for merchandising setup and product layout.

99ROS150KITG

Myriad™ is a trademark of Rose Displays, Ltd. Neither the manufacturer nor any sales agent may be held liable for injury, loss or damage resulting from the use of these products.

500 Narragansett Park Drive Pawtucket, RI 02861 | 800.631.9707 | [www.rosedisplays.com](http://www.rosedisplays.com) | [signware@rosedisplays.com](mailto:signware@rosedisplays.com)

**/rose/displays**  
The Signware™ Specialists

# Myriad™ Kit H

## Graphic Header

**\*Before You begin, please locate and ID all parts listed for assembly**

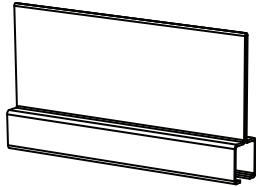

**A** (1) Brand Graphic Holder

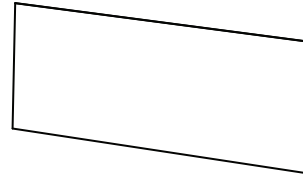

**B** (2) Customer Supplied Graphics

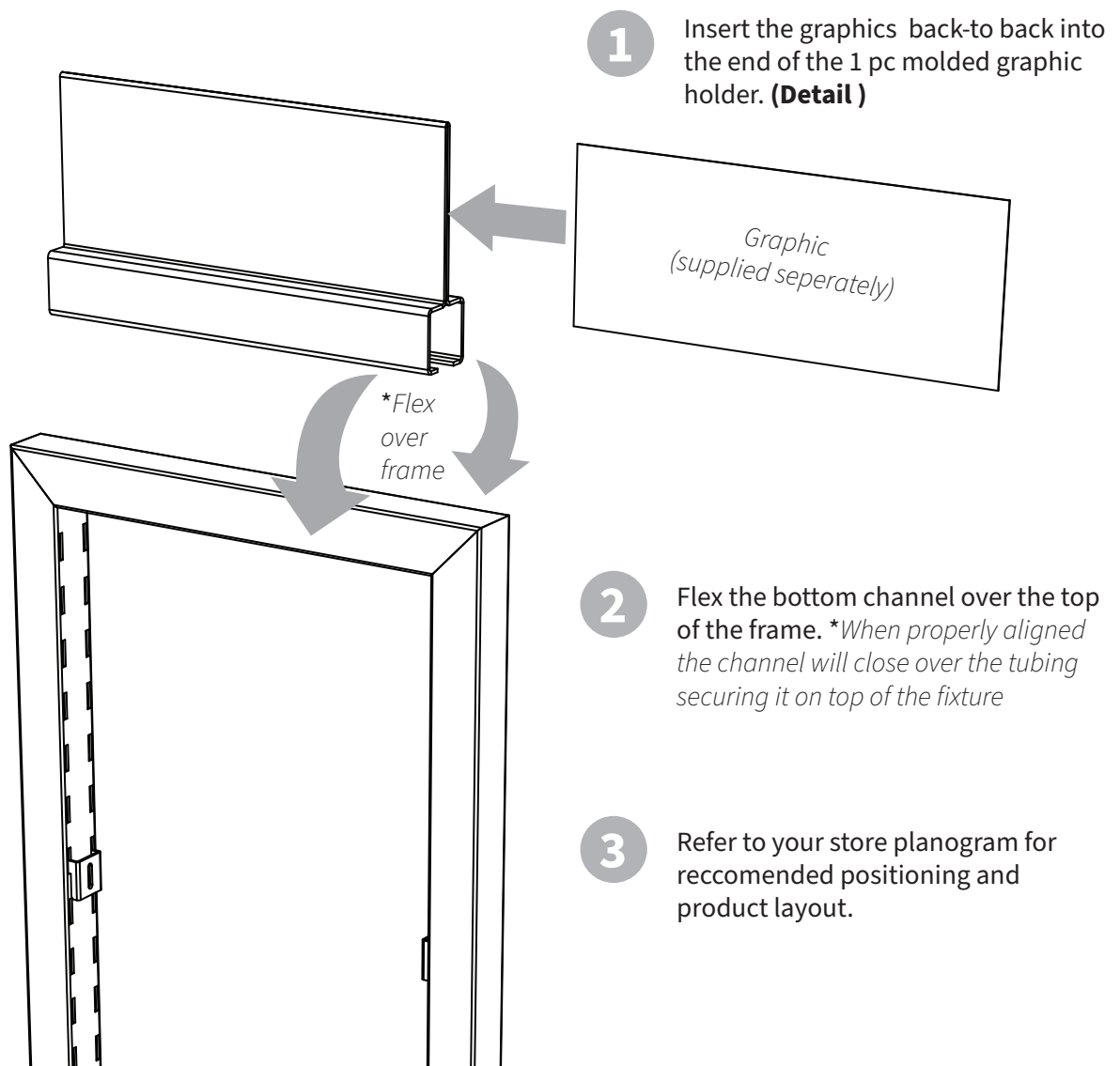

99ROS150KITH

Myriad™ is a trademark of Rose Displays, Ltd. Neither the manufacturer nor any sales agent may be held liable for injury, loss or damage resulting from the use of these products.

500 Narragansett Park Drive Pawtucket, RI 02861 | 800.631.9707 | [www.rosedisplays.com](http://www.rosedisplays.com) | [signware@rosedisplays.com](mailto:signware@rosedisplays.com)

**rose** displays  
The Signware™ Specialists



# Myriad™ Kit I

## Freestanding Banner

**\*Before You begin, please locate and ID all parts listed for assembly**

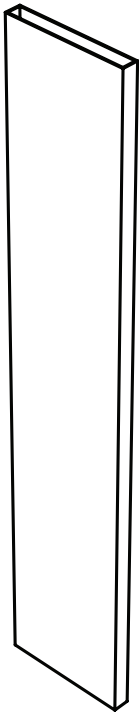

Customer Supplied Graphic

- 1** This kit is designed to slip over Kit C. **(Detail 1)** Pre-assemble the upper frame (Kit C) to either Base Kit A or B as shown in their instructions.

*\*Be careful not to pinch fingers under the ends of the frame tubing.*

- 2** Slip the banner graphic wrap over the top of the tubular frame, then set the assembled display in position.

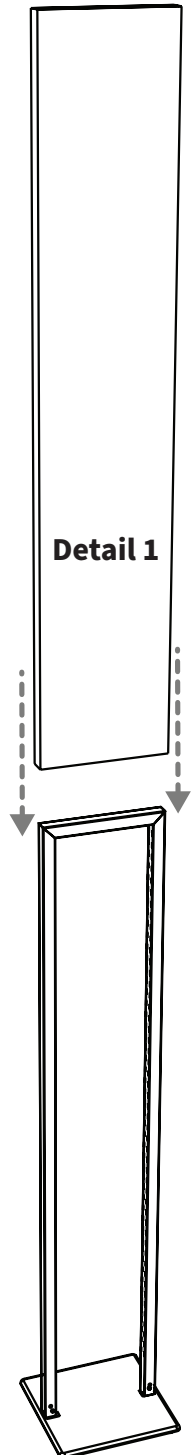

99ROS150KITI

Myriad™ is a trademark of Rose Displays, Ltd. Neither the manufacturer nor any sales agent may be held liable for injury, loss or damage resulting from the use of these products.

500 Narragansett Park Drive Pawtucket, RI 02861 | 800.631.9707 | [www.rosedisplays.com](http://www.rosedisplays.com) | [signware@rosedisplays.com](mailto:signware@rosedisplays.com)

**rose** displays  
The Signware™ Specialists

# Myriad™ Kits J and P

## Footwear Shelves

**\*Before You begin, please locate and ID all parts listed for assembly**



**A** (12) Frame Connector

**B** (6) Shelves - *\*Shelves can be set up 3 ways*

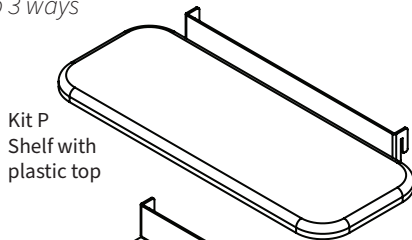

Kit P  
Shelf with  
plastic top

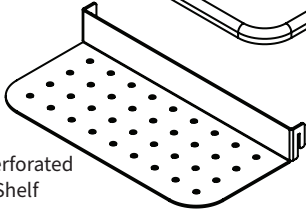

Kit J Perforated  
Metal Shelf

Custom top surface & Graphic Kits  
(minimums apply)

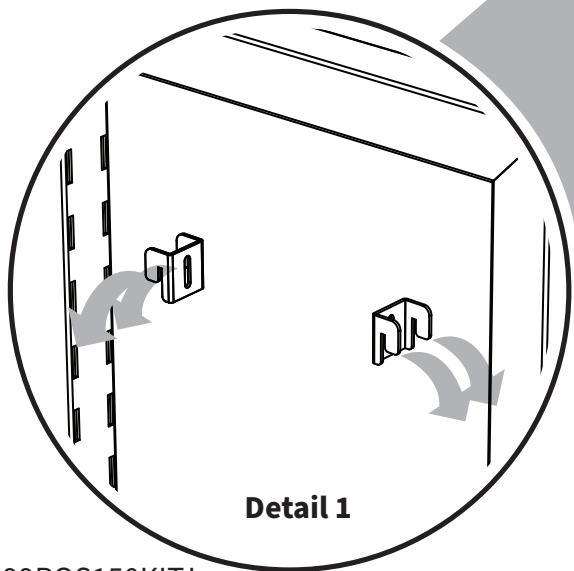

**Detail 1**

**1** Install the frame connector clips into the slots on the inside faces of the frame. **(Detail 1)** - *\*Be sure to count the slot position on the both sides to ensure the shelf installs level.*

**2** Attach the shelves to the frame connector clips.

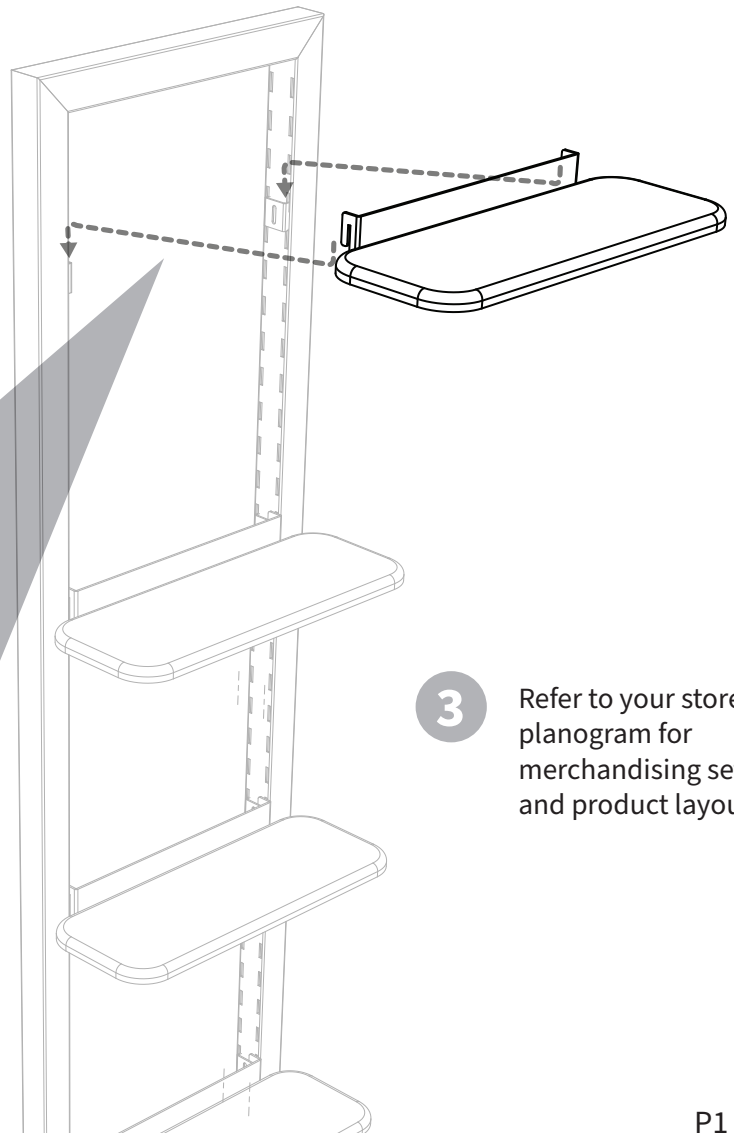

**3** Refer to your store planogram for merchandising setup and product layout.

99ROS150KITJ

P1

Myriad™ is a trademark of Rose Displays, Ltd. Neither the manufacturer nor any sales agent may be held liable for injury, loss or damage resulting from the use of these products.

500 Narragansett Park Drive Pawtucket, RI 02861 | 800.631.9707 | [www.rosedisplays.com](http://www.rosedisplays.com) | [signware@rosedisplays.com](mailto:signware@rosedisplays.com)

**rose/displays**  
The Signware™ Specialists

# Myriad™ Kit K

## Gift Card Tray

**\*Before You begin, please locate and ID all parts listed for assembly**

**A** (10) Clear molded gift card trays

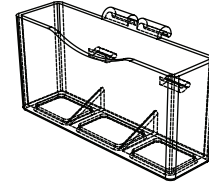

- 1** *If installing on a new frame:* Refer to the Crossbar (Kit D) or Grid Panel (Kit F) instructions to assemble the hangers onto the freestanding frame.  
*If installing on existing fixture:* Clear the intended display area the gift card pockets are to be installed.
- 2** Hook the top of the connection features over the top of the bar (or wire), then gently snap down to lock the tray in place **(Details below)**
- 3** Refer to your store planogram for merchandising setup and product layout.

### Frame with Crossbars

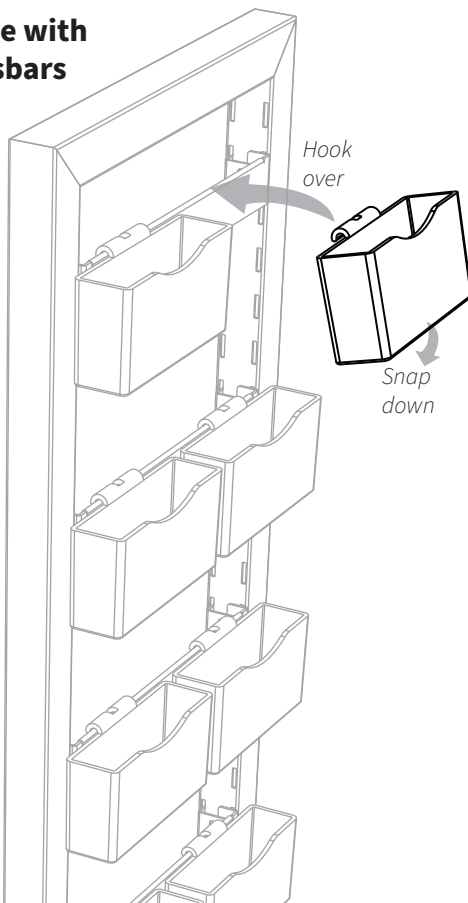

### Frame with Grid

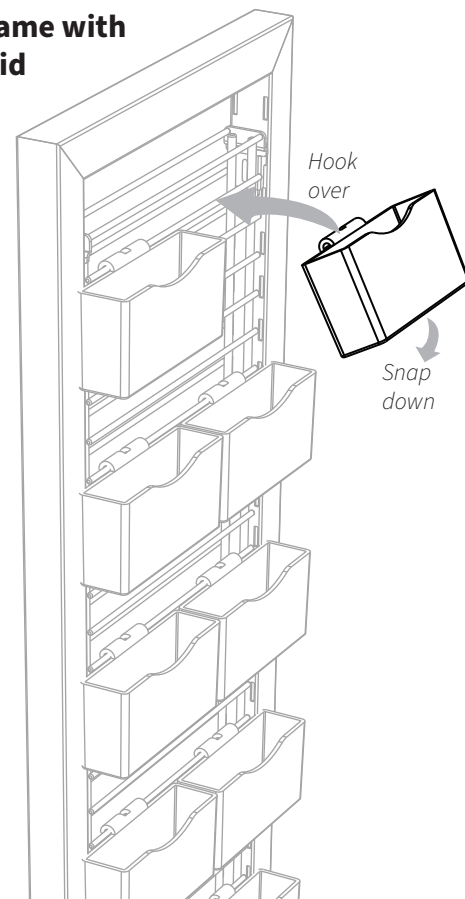

99ROS150KITK

Myriad™ is a trademark of Rose Displays, Ltd. Neither the manufacturer nor any sales agent may be held liable for injury, loss or damage resulting from the use of these products.

500 Narragansett Park Drive Pawtucket, RI 02861 | 800.631.9707 | [www.rosedisplays.com](http://www.rosedisplays.com) | [signware@rosedisplays.com](mailto:signware@rosedisplays.com)

**rose displays**  
The Signware™ Specialists

# Myriad™ Kit L

## Accessory Hangbar

**\*Before You begin assembly, please locate and ID all parts listed for assembly**



**A** (4) Frame Connector

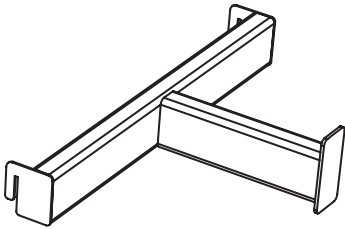

**B** (2) Hangbars

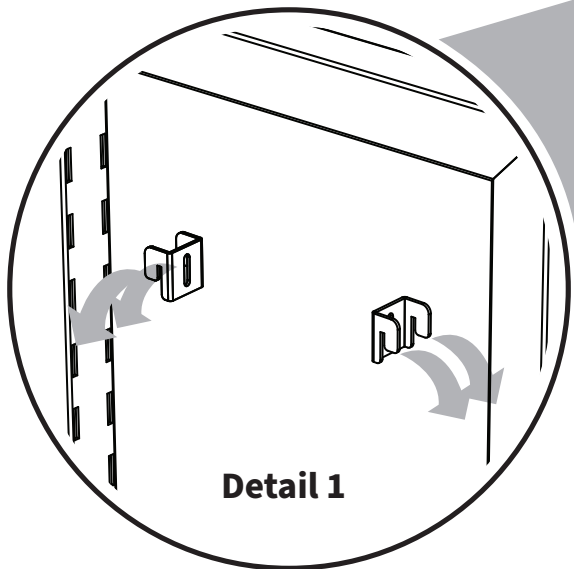

**1** Install the frame connectors into the slots on the inside faces of the frame. **(Detail 1)** - *\*Be sure to count the slot position on the both sides to ensure the hangbar installs level.*

**2** Attach the hangbars to the frame connectors.

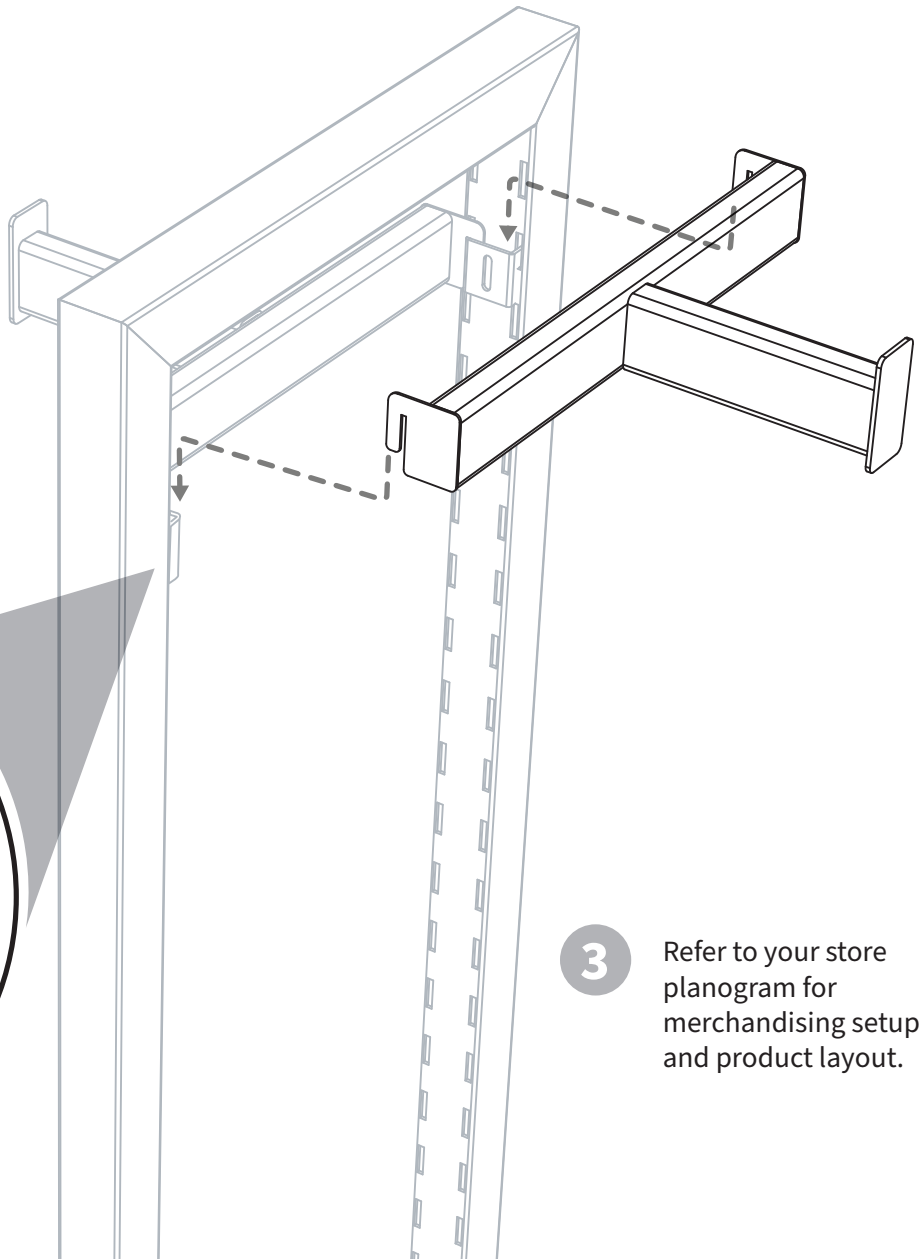

**3** Refer to your store planogram for merchandising setup and product layout.

99ROS150KITL

Myriad™ is a trademark of Rose Displays, Ltd. Neither the manufacturer nor any sales agent may be held liable for injury, loss or damage resulting from the use of these products.

500 Narragansett Park Drive Pawtucket, RI 02861 | 800.631.9707 | [www.rosedisplays.com](http://www.rosedisplays.com) | [signware@rosedisplays.com](mailto:signware@rosedisplays.com)

**rose** displays  
The Signware™ Specialists

# Myriad™ Kit M

## Side Mount Graphic Holder

**\*Before You begin, please locate and ID all parts listed for assembly**

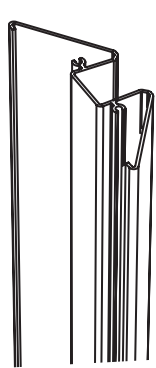

**A** (2) Graphic Channels

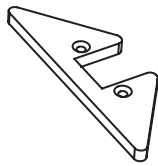

**B** (4) Endcaps



**C** (8) Screws

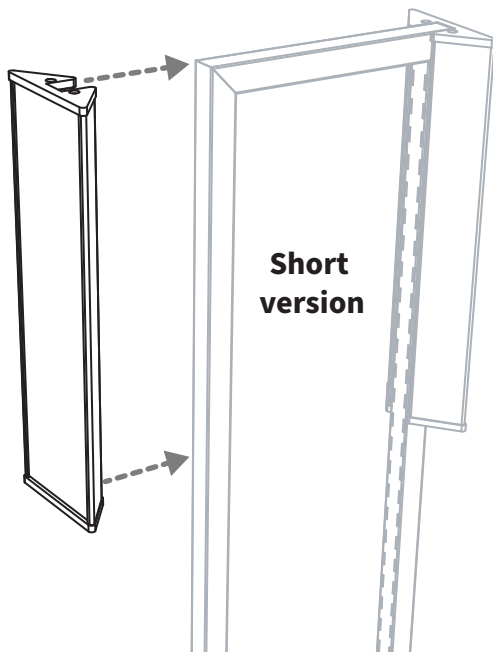

- 1** Press graphic channel onto the outside edge of the frame as shown.   
- \*The channel is designed to friction fit on the frame with a magnetic tape, align in place then assemble to the frame.
- 2** Flex the long edges of the graphic into the features on the channel.

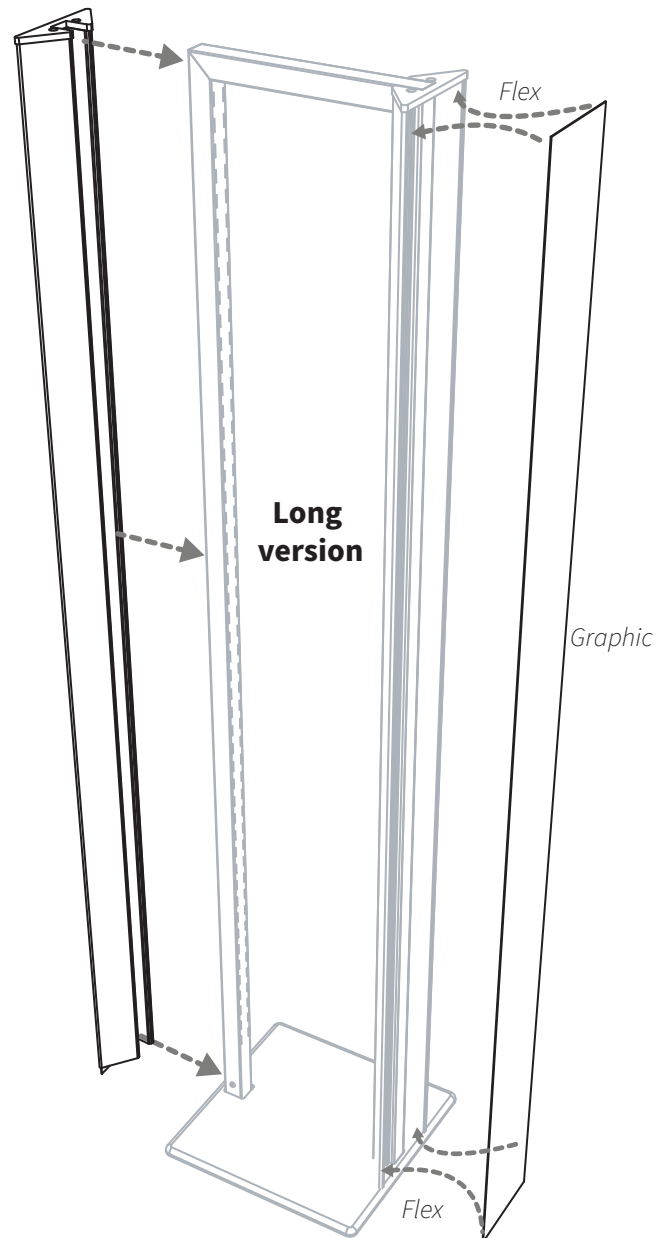

- 3** Refer to your store planogram for merchandising setup and position.

99ROS150KITM

Myriad™ is a trademark of Rose Displays, Ltd. Neither the manufacturer nor any sales agent may be held liable for injury, loss or damage resulting from the use of these products.

500 Narragansett Park Drive Pawtucket, RI 02861 | 800.631.9707 | [www.rosedisplays.com](http://www.rosedisplays.com) | [signware@rosedisplays.com](mailto:signware@rosedisplays.com)

**rose** displays  
The Signware™ Specialists

# Myriad™ Kit N

12pc Hook Set- 4" Long

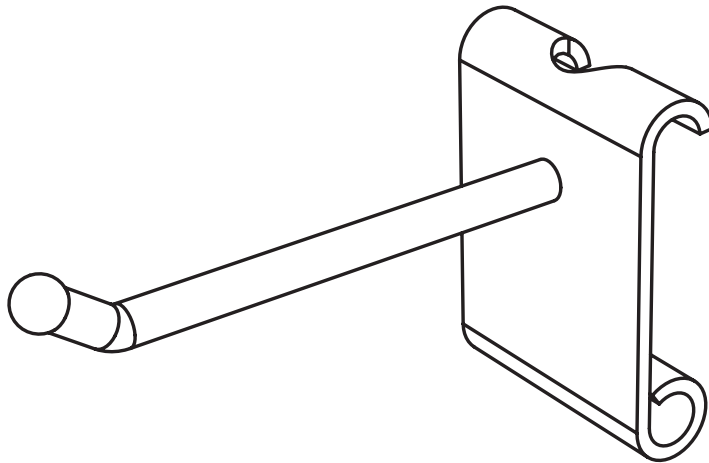

(ROS-150 KitN) 12 pc Hook set - 4" Long

99ROS150KITN

Myriad™ is a trademark of Rose Displays, Ltd. Neither the manufacturer nor any sales agent may be held liable for injury, loss or damage resulting from the use of these products.

500 Narragansett Park Drive Pawtucket, RI 02861 | 800.631.9707 | [www.rosedisplays.com](http://www.rosedisplays.com) | [signware@rosedisplays.com](mailto:signware@rosedisplays.com)

**rose** displays  
The Signware™ Specialists

# Myriad™ Kit O

6pc Frame Connector Kit

---

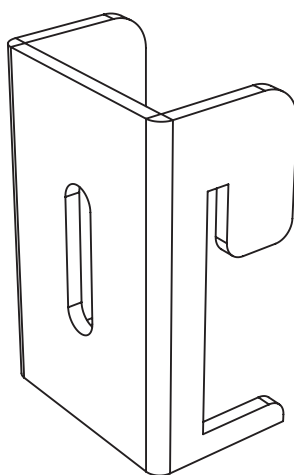

(ROS-150 KitO) 6pc Frame Connector Set

99ROS150KITO

Myriad™ is a trademark of Rose Displays, Ltd. Neither the manufacturer nor any sales agent may be held liable for injury, loss or damage resulting from the use of these products.

500 Narragansett Park Drive Pawtucket, RI 02861 | 800.631.9707 | [www.rosedisplays.com](http://www.rosedisplays.com) | [signware@rosedisplays.com](mailto:signware@rosedisplays.com)

**rose** displays  
The Signware™ Specialists

# Systems

## Myriad™ Kits J and P Footwear Shelves

**\*Before You begin, please locate and ID all parts listed for assembly**



**A** (12) Frame Connector

**B** (6) Shelves - *\*Shelves can be set up 3 ways*

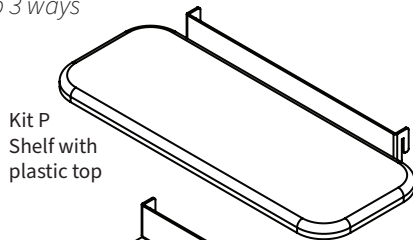

Kit P  
Shelf with  
plastic top

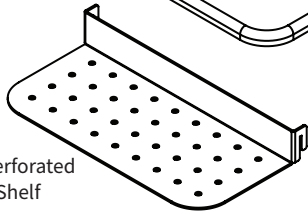

Kit J Perforated  
Metal Shelf

Custom top surface & Graphic Kits  
(minimums apply)

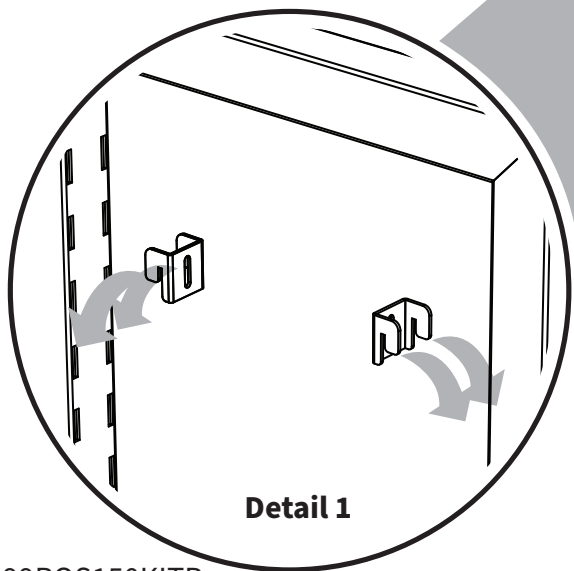

**Detail 1**

**1** Install the frame connector clips into the slots on the inside faces of the frame. **(Detail 1)** - *\*Be sure to count the slot position on the both sides to ensure the shelf installs level.*

**2** Attach the shelves to the frame connector clips.

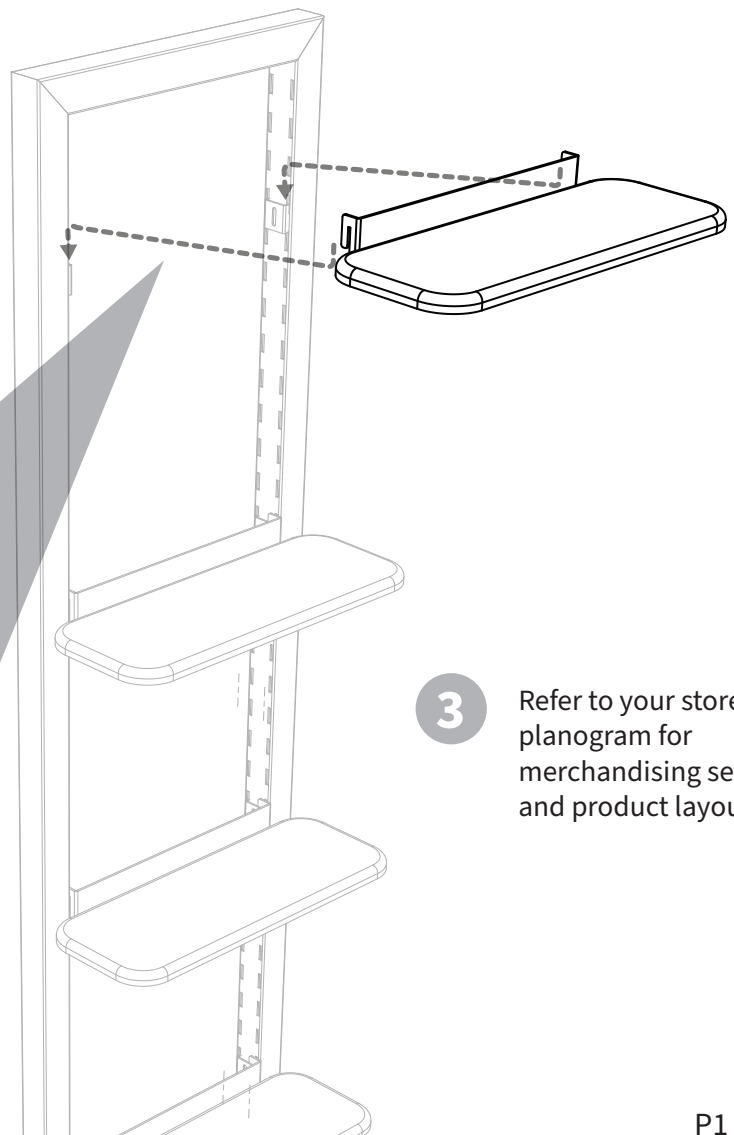

**3** Refer to your store planogram for merchandising setup and product layout.

99ROS150KITP

P1

Myriad™ is a trademark of Rose Displays, Ltd. Neither the manufacturer nor any sales agent may be held liable for injury, loss or damage resulting from the use of these products.

500 Narragansett Park Drive Pawtucket, RI 02861 | 800.631.9707 | [www.rosedispays.com](http://www.rosedispays.com) | [signware@rosedispays.com](mailto:signware@rosedispays.com)

**rose/displays**  
The Signware™ Specialists