

Myriad™ Kit A

Graphic/Storage Base

***Before You begin assembly, please locate and ID all parts listed**

A (2) Top Connectors



B (2) Bottom Connectors



C (1) Bottom Cover

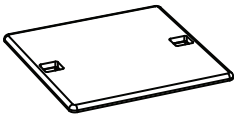

D (1) Base Bottom

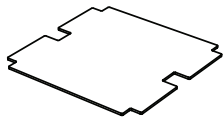

E (4) Base coroplast panels

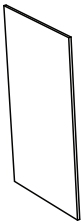

**Graphics supplied by others*

F&G (2) Side Frames

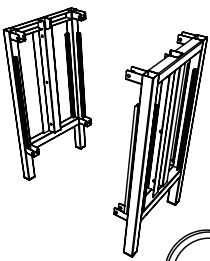

H (2) Clevis Pins



1 1A) Align and install the 4 base cross tube connectors onto one of the side frames. Be sure to align the locking feature with the holes in the connectors. Depress and slide the top frame connectors into place until they click. **(Illustration 1)**. 1B) Next install the remaining side onto the base cross connectors.

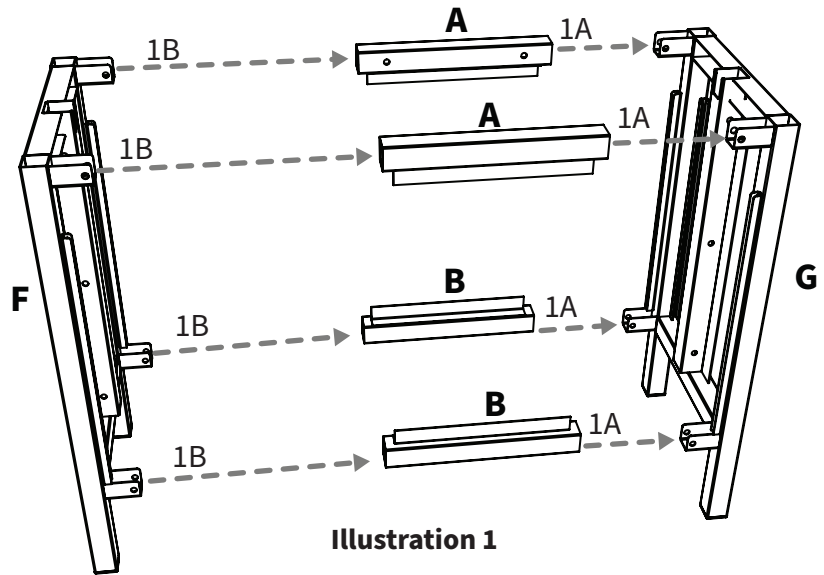

Illustration 1

2 Insert the base bottom into the assembly (on an angle) as shown. Lay flat on top of the inside base frame **(Illustration 2)**.

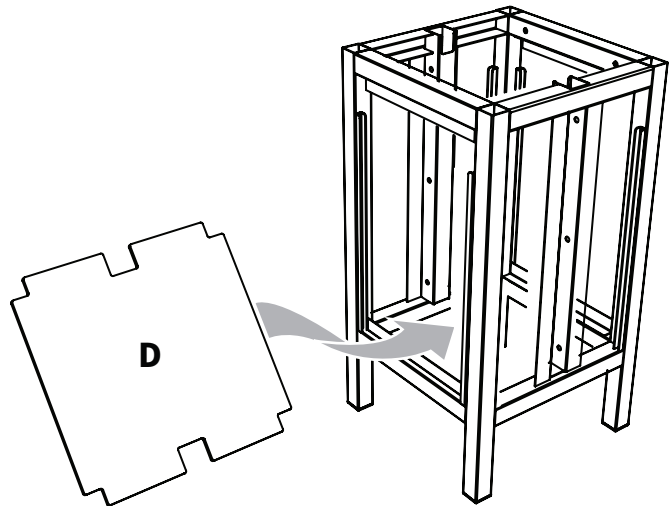

Illustration 2

99ROS150KITA

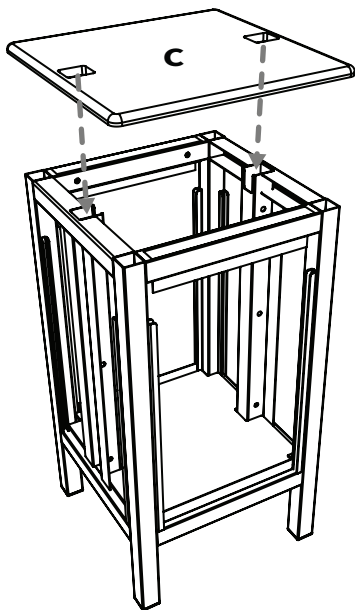
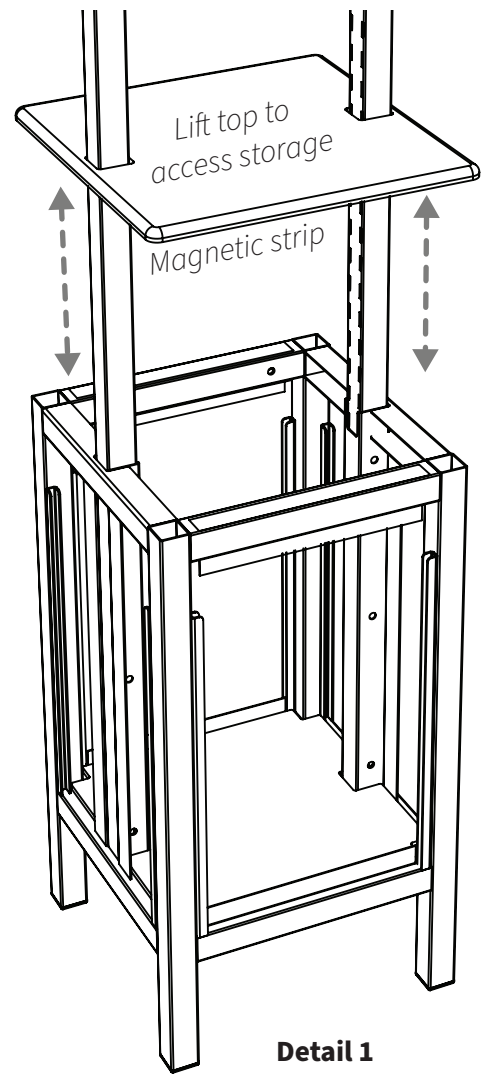

Illustration 3

3 The top cover of the base is magnetic. Place the base top onto the assembled base frame. (Be sure to align the holes in the top with the inner frame channels inside the base assembly) - **Illustration 3**.

4 Slip the upper frame through the square holes on the base cover and into the channels in the base. (*refer to the instructions on upright page for interlocking and height adjustment).

5 Slip the base graphics into the top corners of the channels. Carefully flex the graphic as you slip them downward into position. - **Detail 2** (Repeat this step on the other three sides)



Detail 1

*To Assemble Upper Frame:
Refer to Frame Kit C
Assembly Instruction Sheet

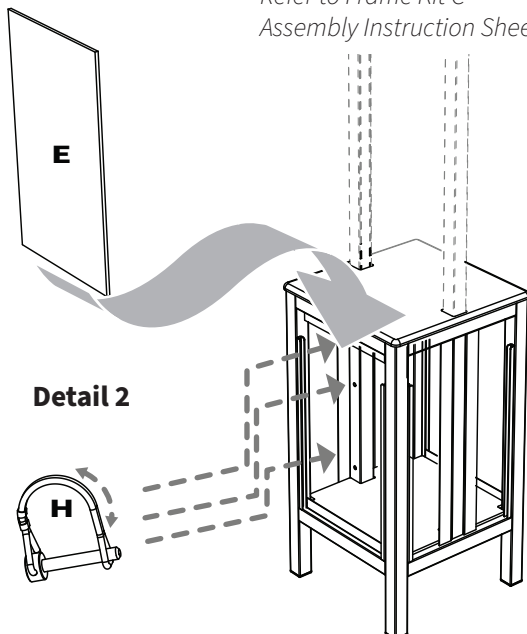

Detail 2

***The base can be used to store extra parts, merchandising accessories or extra product**

6 To access storage you can either:
A) Remove accessory merchandising kits from the bottom of the upper frame then lift the top cover (**Detail 1**).

Or:

B) Gently Pull the graphic up and out of the front or back graphic channels (**Detail 2**).

7 Refer to the instruction sheet included with the merchandising accessory kit along with your store planogram for merchandising setup and product layout.